



Company: REDROCK MICRO

Pages: 1 of 1

Title: ultra eyeSpy DSLR SETUP GUIDE

Scene: ultra eyeSpy DSLR BASIC and DELUXE Bundles

Date: 04.01.12

ultra eyeSpy BASIC Bundle Components

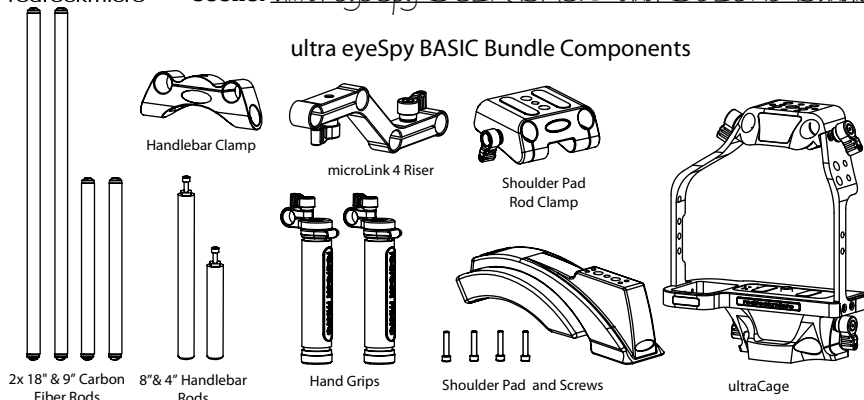

ultra eyeSpy Additional Options

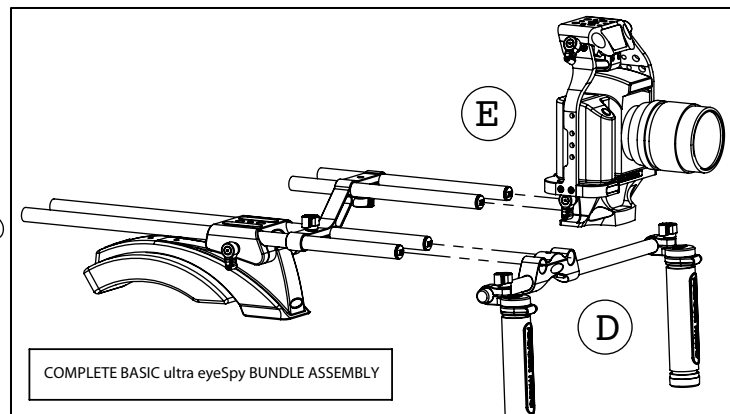
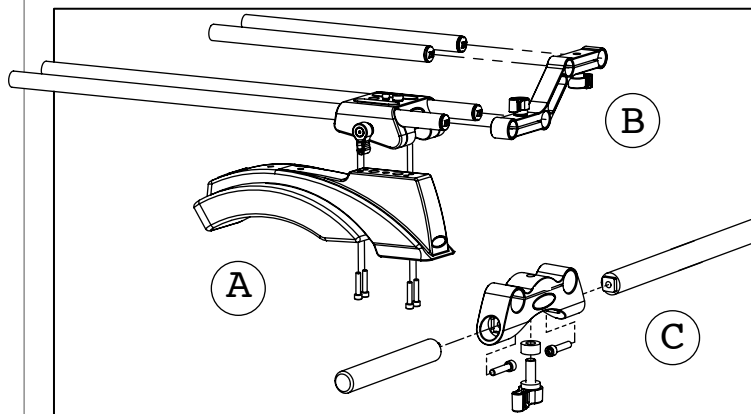
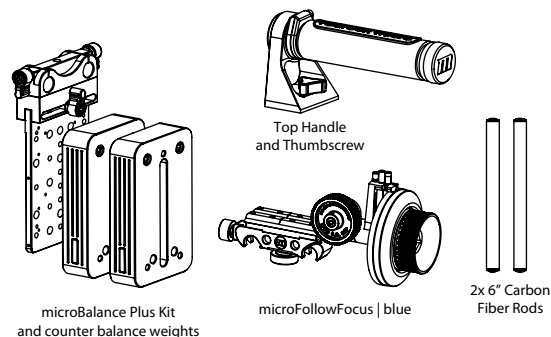

A: Attach Shoulder Pad to Rod Clamp using screws. Insert 18" Rods.
B: Insert 18" and 9" Rods into microLink 4 Riser as shown.
C: Remove blue knob from Handlebar Clamp. Attach 4" and 8" grip rods using screws. Replace blue knob.

D: Add Handlebar and blue Hand Grips.
E: Slide ultraCage onto front 9" Rods as shown.

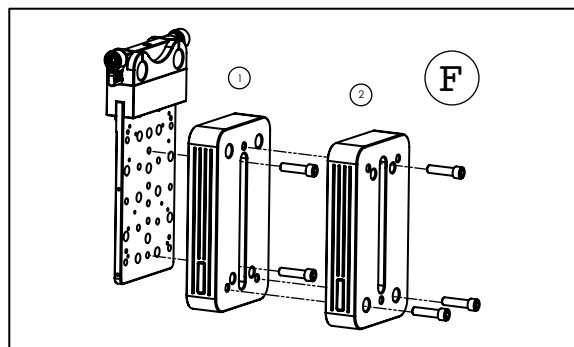

Note: when using Top Handle, Triangle Thumb screw replaces 1/4-20 x 3/8" screw at top of cage into camera.

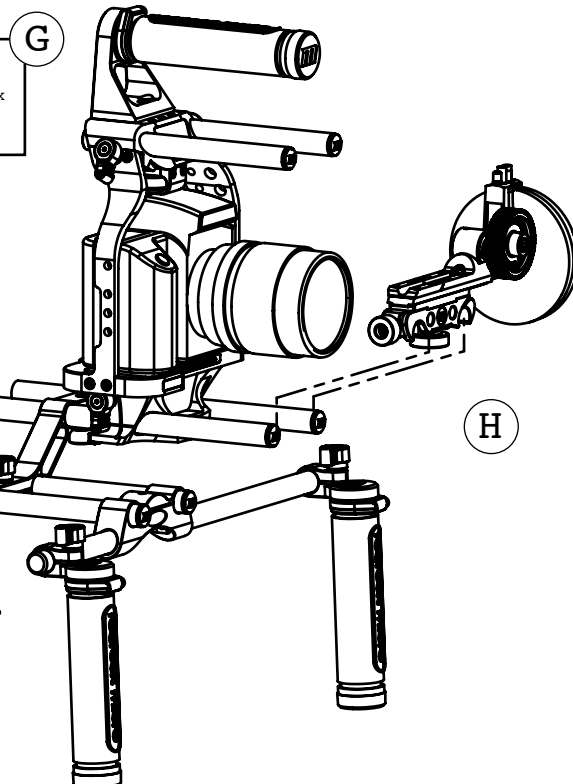

ADDITIONAL OPTIONS

F: Attach Add-On Weights to microBalance Plus. Slide in place onto rig.
G: Attach Top Handle (see above note) and 6" Carbon Fiber Rods to top of ultraCage.
H: Attach microFollowFocus | blue to rig and microLens Gear to camera lens.

