

5D/7D & SC3 SHOE CLAMP INSTRUCTIONS

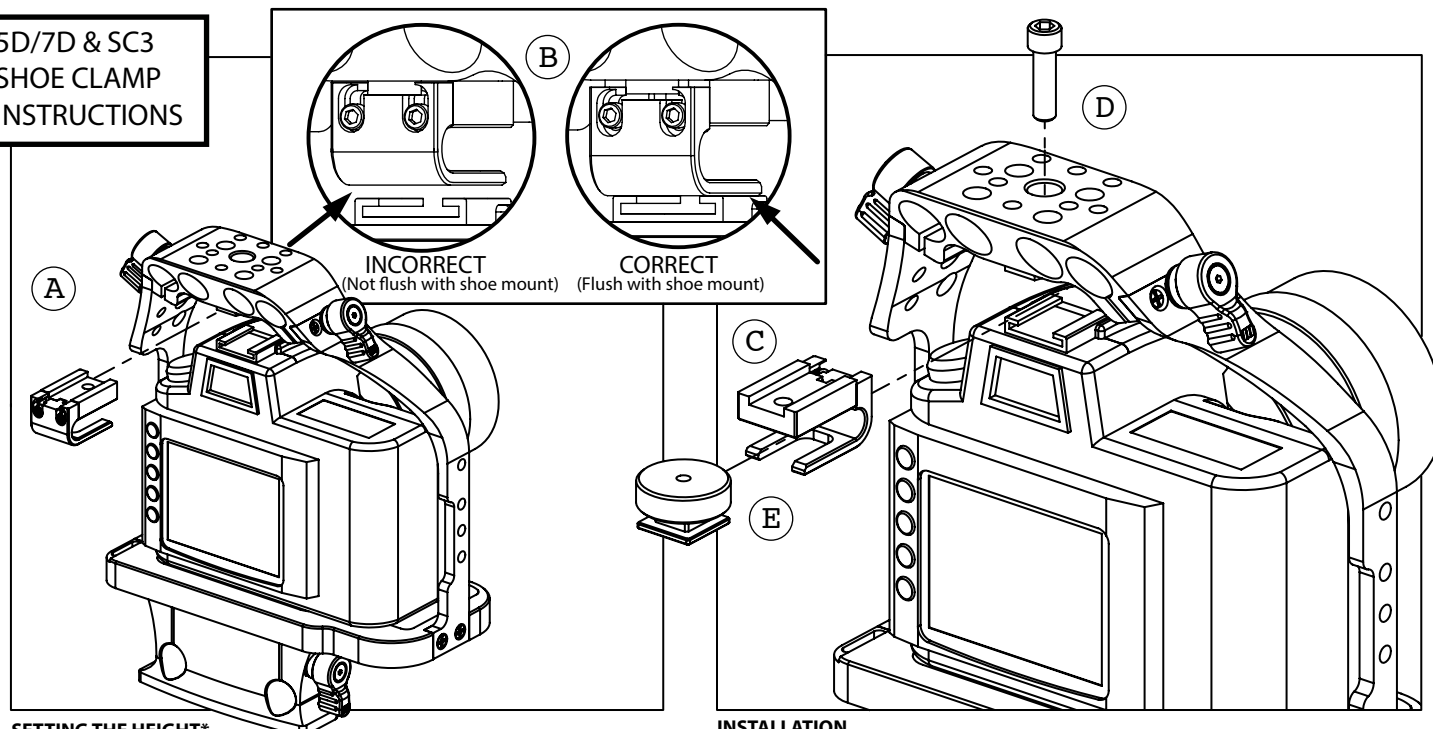

SETTING THE HEIGHT*

- A: With camera secured to cage with camera screw, insert the Shoe Clamp Spacer BACKWARDS as shown.
- B: Loosen front screws with hex key. Adjust height of Spacer so that it is flush with camera shoe mount.
- *FAILURE TO ADJUST CORRECT HEIGHT MAY CAUSE DAMAGE TO CAMERA.**

INSTALLATION

- C: Insert Shoe Clamp Spacer CORRECTLY as shown.
- D: Tighten 1/4"-20 x 7/8" screw from top of cage into Spacer.
- E: Insert Thumbwheel/Shoe securely in spacer and camera shoe mount. Tighten Thumbwheel until camera is secure. Avoid overtightening.

D800 SHOE CLAMP INSTRUCTIONS

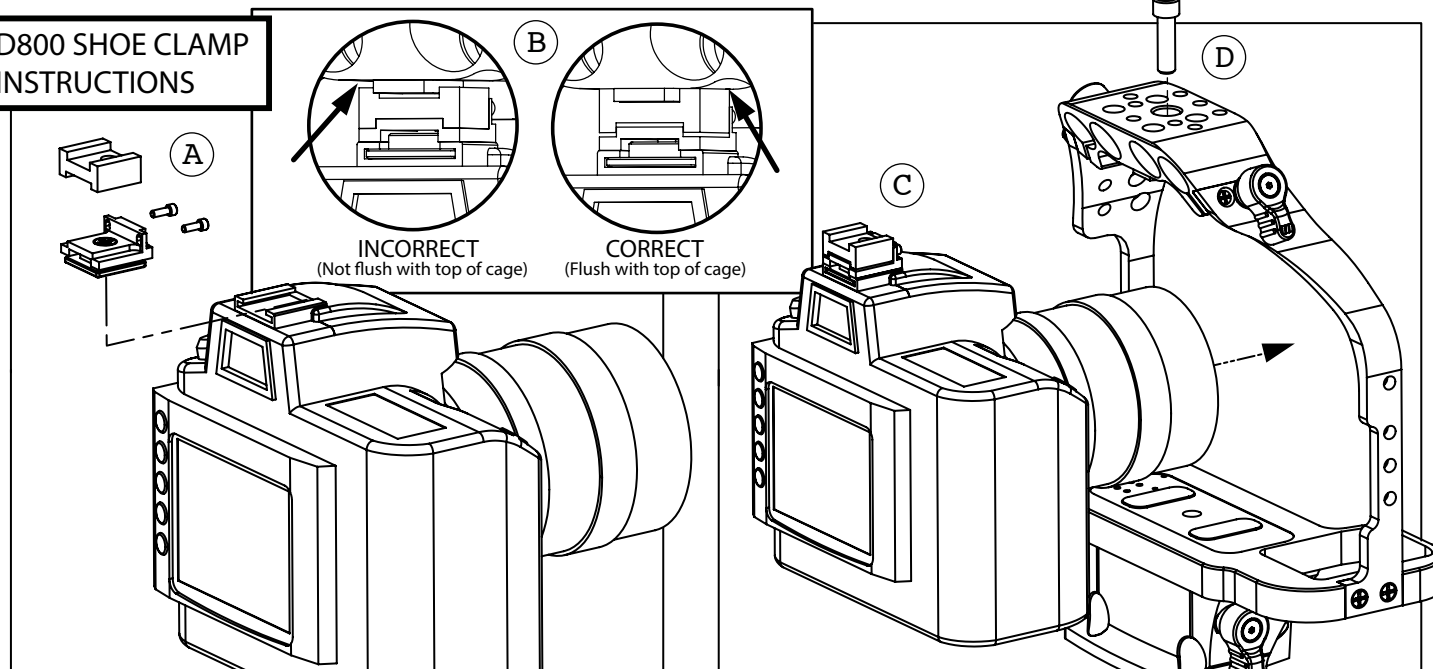

SETTING THE HEIGHT*

- A: Remove front screws and disassemble Shoe Clamp. Tighten screw to secure Shoe to camera as shown. Once tight, reassemble Shoe Clamp.
- B: With front screws loosened, adjust height of Spacer so that it is flush with top of cage when camera is in place. This may take some trial and error. ***FAILURE TO ADJUST CORRECT HEIGHT MAY CAUSE DAMAGE TO CAMERA.**

INSTALLATION

- C: When height is correctly adjusted, tighten front screws so Shoe Clamp is secured to camera.
- D: Slide camera into place. Tighten camera screw from underneath ultraBase into camera with flat-head screwdriver. Tighten 1/4"-20 x 7/8" screw from top of cage into Shoe Clamp.