

microMattebox CLAMP-ON ADAPTER

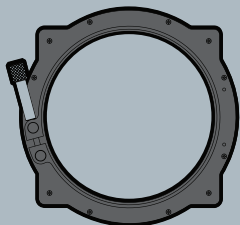

microMattebox clamp-on Adapter



Support Bracket

⊗ ⊔ 2-56 screws (x 11)

⊕ ⊔ 6-32 screws (x 2)

KIT INCLUDES:

- microMattebox clamp-on adapter
- Support Bracket

This guide details installation of the clamp-on adapter to your current Redrock microMattebox. See additional guide for Clamp-On user instructions.

1

REMOVE SWING-AWAY PORTION OF YOUR MATTE BOX

A

Loosen the two thumbscrews fully to remove your matte box's hinge assembly.

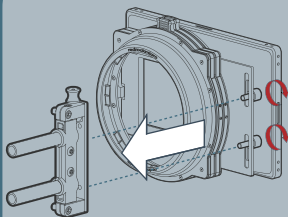

B

Remove stock lens adapter from the back of the matte box. Save screws for later use (optional)

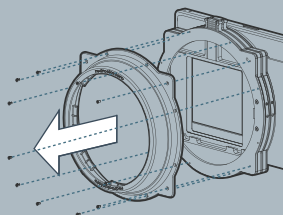

2

INSTALL CLAMP-ON ADAPTER

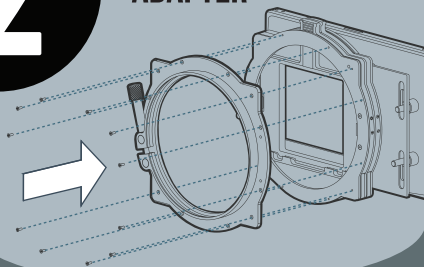

Use provided 2-56 screws to install Clamp-on Adapter to your matte box. Make sure the adapter is oriented as shown.

3

INSTALL BRACKET

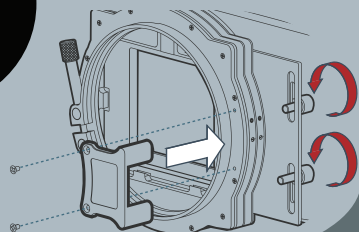

Install bracket using two 6-32 screws. Secure bracket to matte box frame by tightening existing thumbscrews. The bracket is optional but it prevents your mattebox from unexpected rotation.