



redrockmicro

**Title:** *microFollowFocus | blue*  
**Scene:** *microFollowFocus | blue setup and operation*

#### FEATURES

- (A) Adjustable Indicator Arm
- (B) Adjustable Hard Stops (shown in 'parked' position)
- (C) Drive Gear
- (D) Glow-In-The-Dark Marking Disk
- (E) Backlash Adjustment
- (F) Backlash Lock
- (G) Rod Clamp Knob
- (H) Sliding Arm

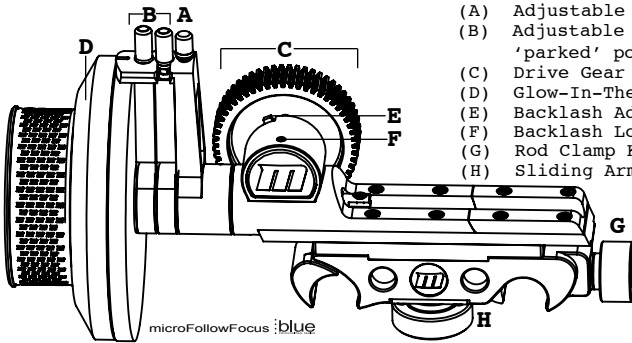

microFollowFocus :blue

#### STEP 1

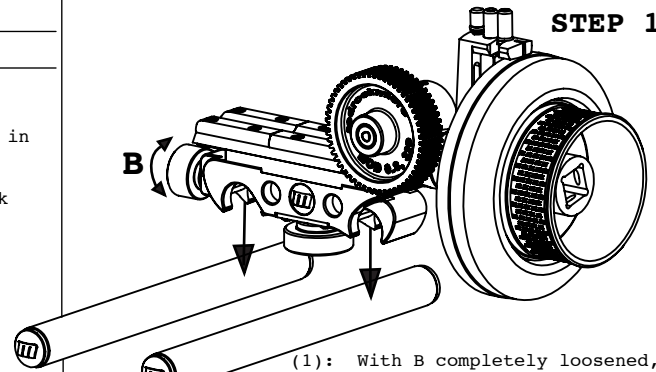

- (1): With B completely loosened, attach microFollowFocus onto 15mm rods by pushing down. No need to slide on.
- (2): Tighten rod clamp knob to secure follow focus

#### STEP 2 GEAR ALIGNMENT

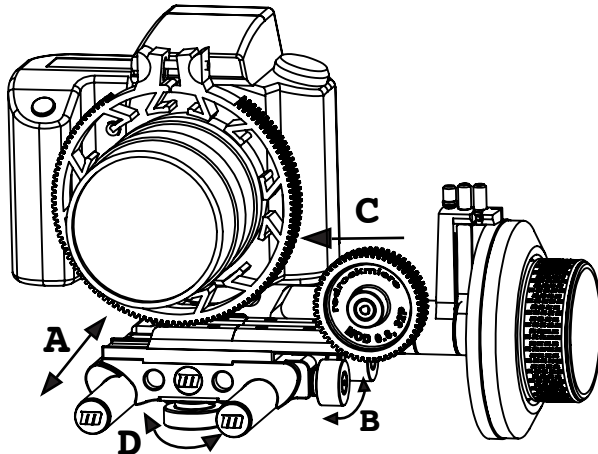

- (1): Prior to tightening rod clamp, align drive gear with lens gear. Once aligned, tighten (B)
- (2): Move sliding arm (C) towards lens until drive gear meshes with lens gear and tighten (D)

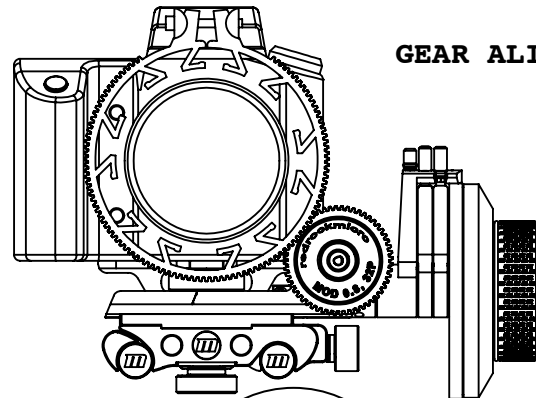

#### HELPFUL HINT

Don't mesh drive gear with lens gear too tightly or follow focus will feel 'crunchy'

#### HARD STOPS / INDICATOR ARM

(A): Adjustable Hard Stops can be positioned around the focus wheel to create a stop for your lens. To set Hard Stops, (1) move each Hard Stop from its parked position by lifting the knob up and moving to desired position on focus wheel. Once in the desired location (2) twist to tighten knob to set the Hard Stop. When turning the focus wheel, the wheel can then rotate until the Hard Stop hits the focus indicator arm.

(B): Adjustable Indicator Arm can be adjusted left or right. To adjust, loosen Indicator Arm knob and adjust to the desired position. Tighten knob to set the adjustment. Indicator Arm can be positioned at any point around the focus wheel.

**IMPORTANT:** When re-parking Hard Stops into Focus Indicator Arm, you must first loosen the hard stop. Re-seating the hard stops without loosening may "lock up" the follow focus.

FOR ADDITIONAL INFORMATION ON microFollowFocus FEATURES, PLEASE VIEW THE TUTORIAL VIDEO AT [start.redrockmicro.com](http://start.redrockmicro.com)

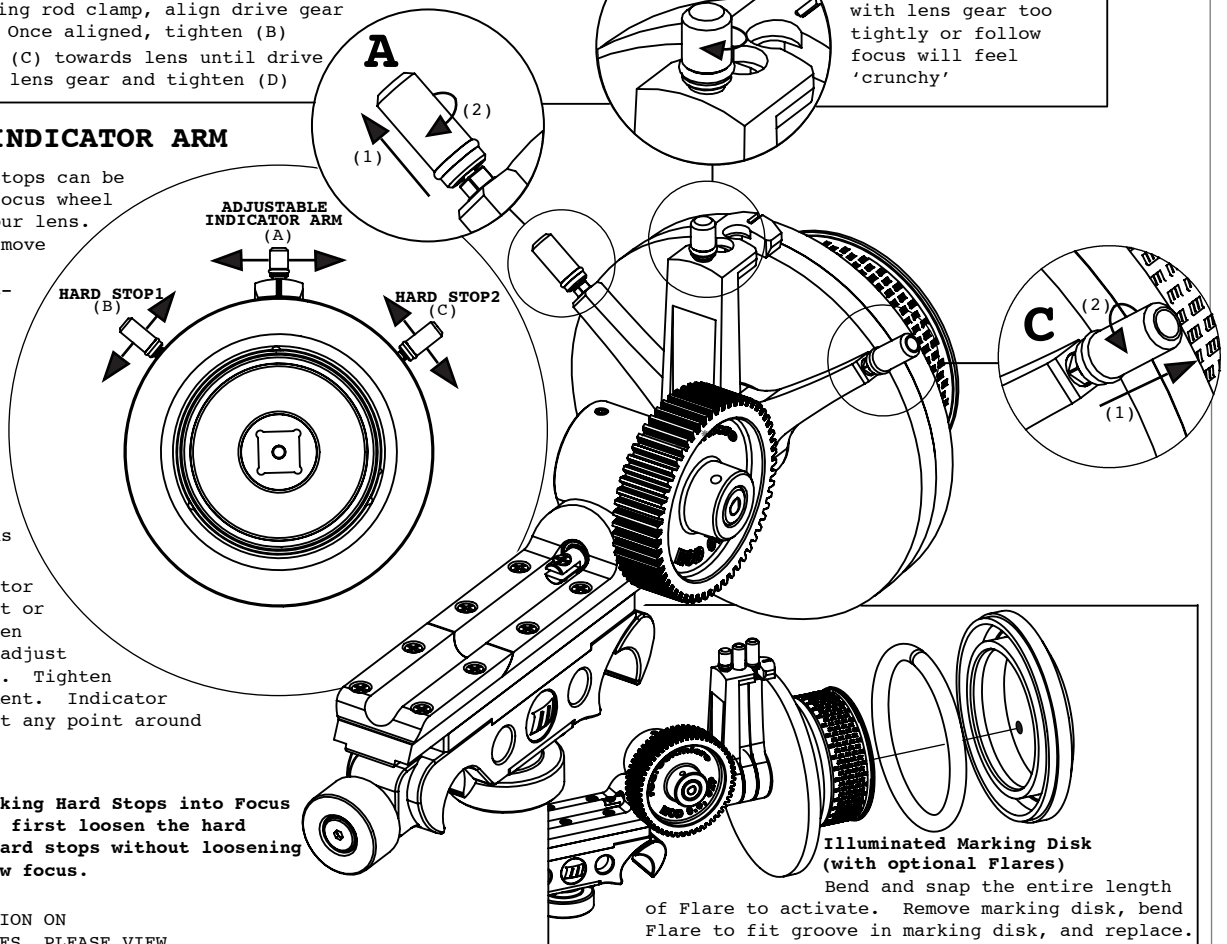

#### Illuminated Marking Disk (with optional Flares)

Bend and snap the entire length of Flare to activate. Remove marking disk, bend Flare to fit groove in marking disk, and replace.

create the cinema experience



<http://start.redrockmicro.com>  
Tutorials, forums, customer support