

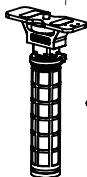

redrockmicro

Title: GRIPPIT
Scene: Redrock Micro's HD SLR NANO Series

Cast Required:



DSLR Baseplate
Handgrip
Assembly*

Camera
set screw



Optional
Lip Pad

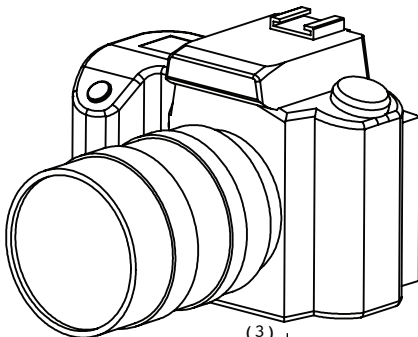

*Handgrip and DSLR Baseplate
come preassembled

(2) Optional Lip Pad Assembly

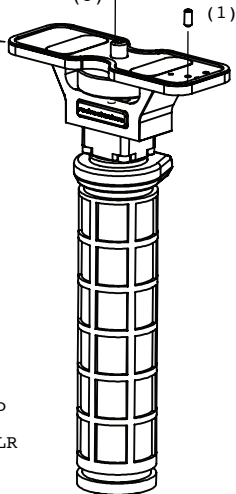
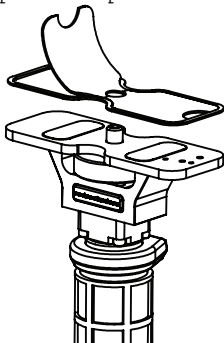

- (1) Add camera specific set screw to DSLR Baseplate
- (2) OPTIONAL: Attach Lip Pad to DSLR Baseplate
- (3) Attach camera to DSLR Baseplate

NOW GO SHOOT!



create the cinema experience

<http://start.redrockmicro.com>

Tutorials, forums, customer support