

COMMANDER™

for FREEFLY MoVI Pro / XL

CALIBRATION

Commander is factory calibrated for optimal performance. It is not typically recommended to recalibrate your unit in the field. In the rare case that your Commander needs to be re-calibrated, install the MIMIC, power on, and follow these steps:

- 1 With the Commander in White mode, press in and hold the Commander's joystick [A]. Press and release the CAL button [B]. When Commander's LED indicator [C] turns yellow, release the joystick. Perform calibration by following these steps:

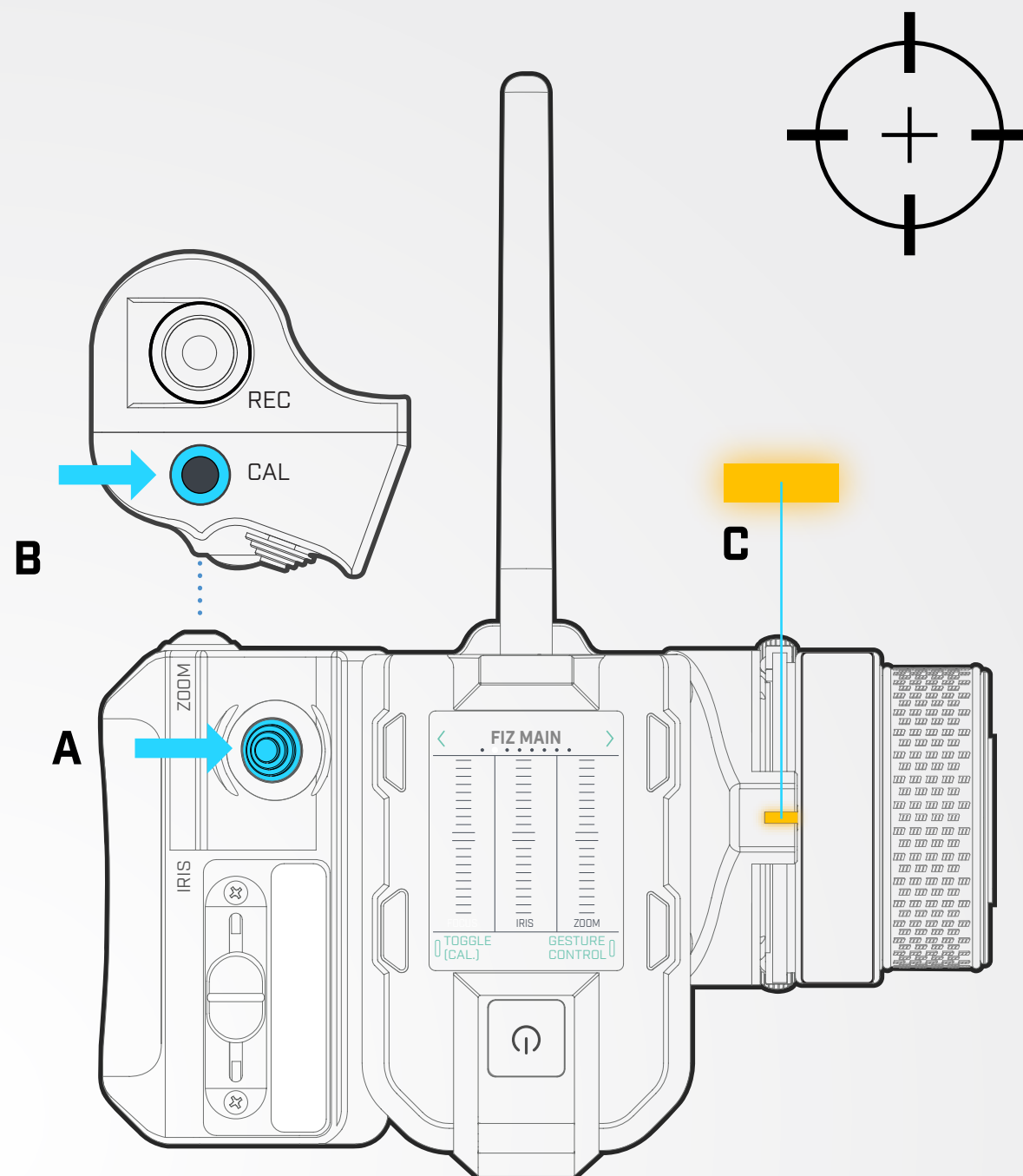

2

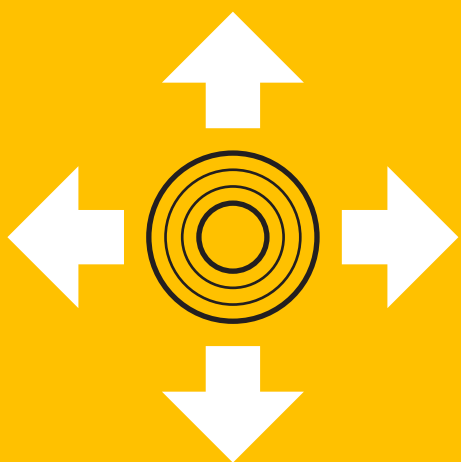

Move the Joystick gently in each direction: up, down, left, right.

3



With hardstops in their max positions, turn the Focus Knob clockwise until it stops. Turn counterclockwise until it stops.

4

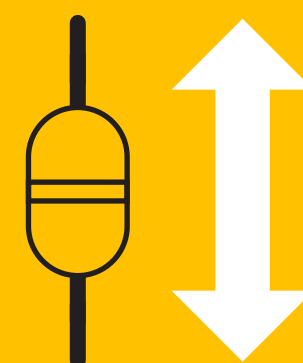

Push the Iris Slider up until it stops. Push it down until it stops.

5

Press the CAL button. **Be careful not to touch any controls** until the Commander's Indicator light turns white. Then check Calibration, next page.

MAX

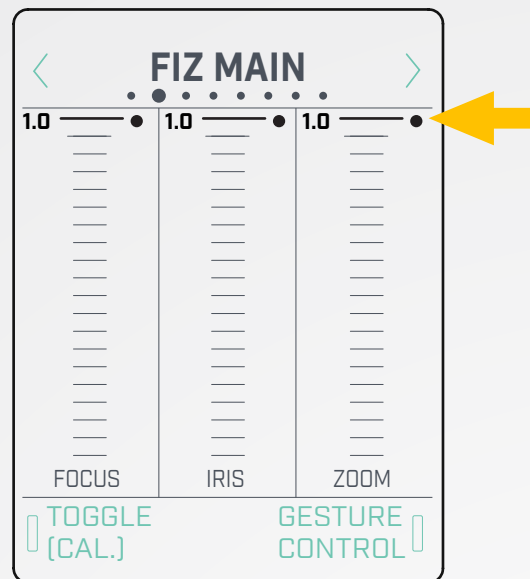
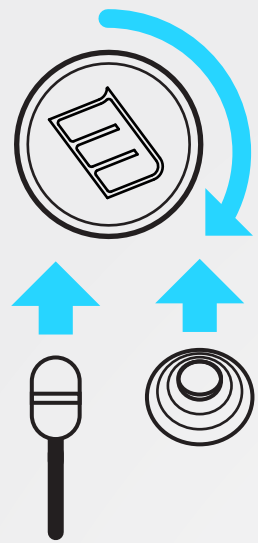

After the Commander's indicator light turns white, enter the 'FIZ MAIN' screen on the MIMIC. Watch the sliders as you move the Commander's controls.

When each control reaches its max position the corresponding slider on the MIMIC should reach its max position [1.0]. When each control reaches its min position its slider on the Mimic should reach its min position [.00].

If any slider on the MIMIC stops short of the endpoint OR 'wraps' around to the other end, **YOU MUST RE-CALIBRATE**. Try varying pressure on the Commander controls as you repeat steps 1 - 5.

In gimbal mode [blue] check gimbal pan/tilt/roll. If the Commander's joystick has poor performance or feel, **RE-CALIBRATE**.

MIN

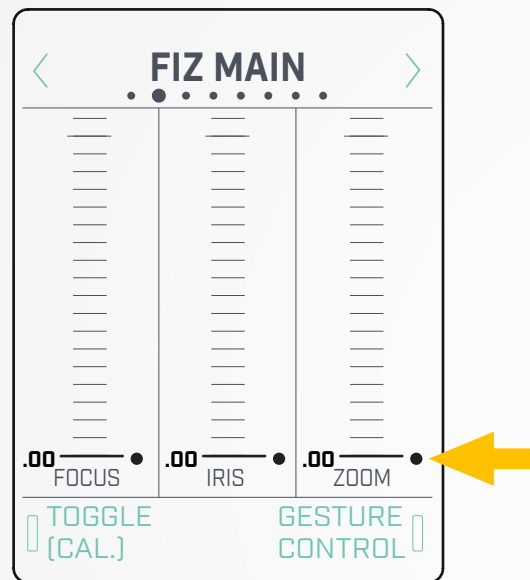
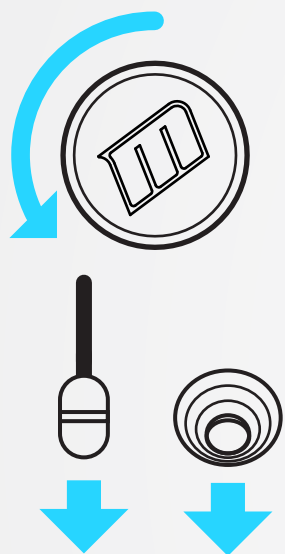

NOTE: Focus, Iris, and Zoom controls must be **individually calibrated EACH time** you enter calibration mode. Failure to perform any one of steps 2, 3, or 4 will result in a failed calibration and the Commander will not operate.

It may take a few tries to calibrate your Commander for optimal performance, which is why it is not usually recommended to change the factory calibration. If you need further assistance, watch the Commander Calibration Support Video or contact Redrock Support.

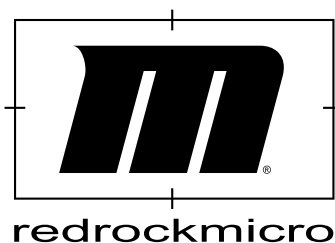

FREEFLY, MOVI, MOVI PRO, and MIMIC are trademarks or registered trademarks of Freefly Systems Inc. in the USA and other countries.

