

COBALT CAGE

FOR GoPro
HERO3

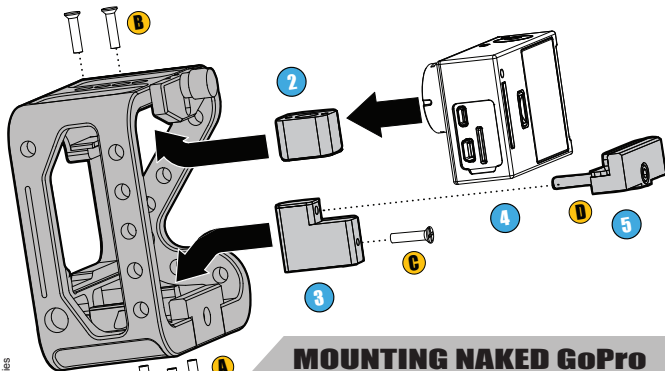

MOUNTING NAKED GoPro

*Requires the optional Deluxe Accessory Kit

1. Loosen screws (A) slightly and lower Bottom Plate. It is not necessary to remove screws or bottom plate completely.
2. Install Top Insert as shown. Secure from top of cage with screws (B).
3. Place Bottom Insert into groove at bottom of cage. Tighten screw (C) from bottom insert into bottom plate.
4. Push camera into place in cage, flush with front surface. Guides on the cage will locate camera. Tighten screws (A).
5. Install any GoPro accessories then install L Bracket. Tighten screw (D) as shown.

MOUNTING HOUSED GoPro

1. Loosen thumbscrew, slide up **Top Locking Bracket** and tighten.
2. Position GoPro **Waterproof Housing Accessory Feet** into cage as shown.
3. Once in position, push camera into place, upright in cage. Slide **Top Locking Bracket** down and tighten thumbscrew.

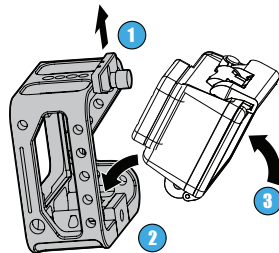

<http://start.redrockmicro.com>
TUTORIALS AND CUSTOMER SUPPORT